

SPRING MILL STATE PARK

Electric & Primitive

Our Wandering Kitchen Recommendations

- Favorite sites
- Good sites for multiples, in addition to the favorites in purple

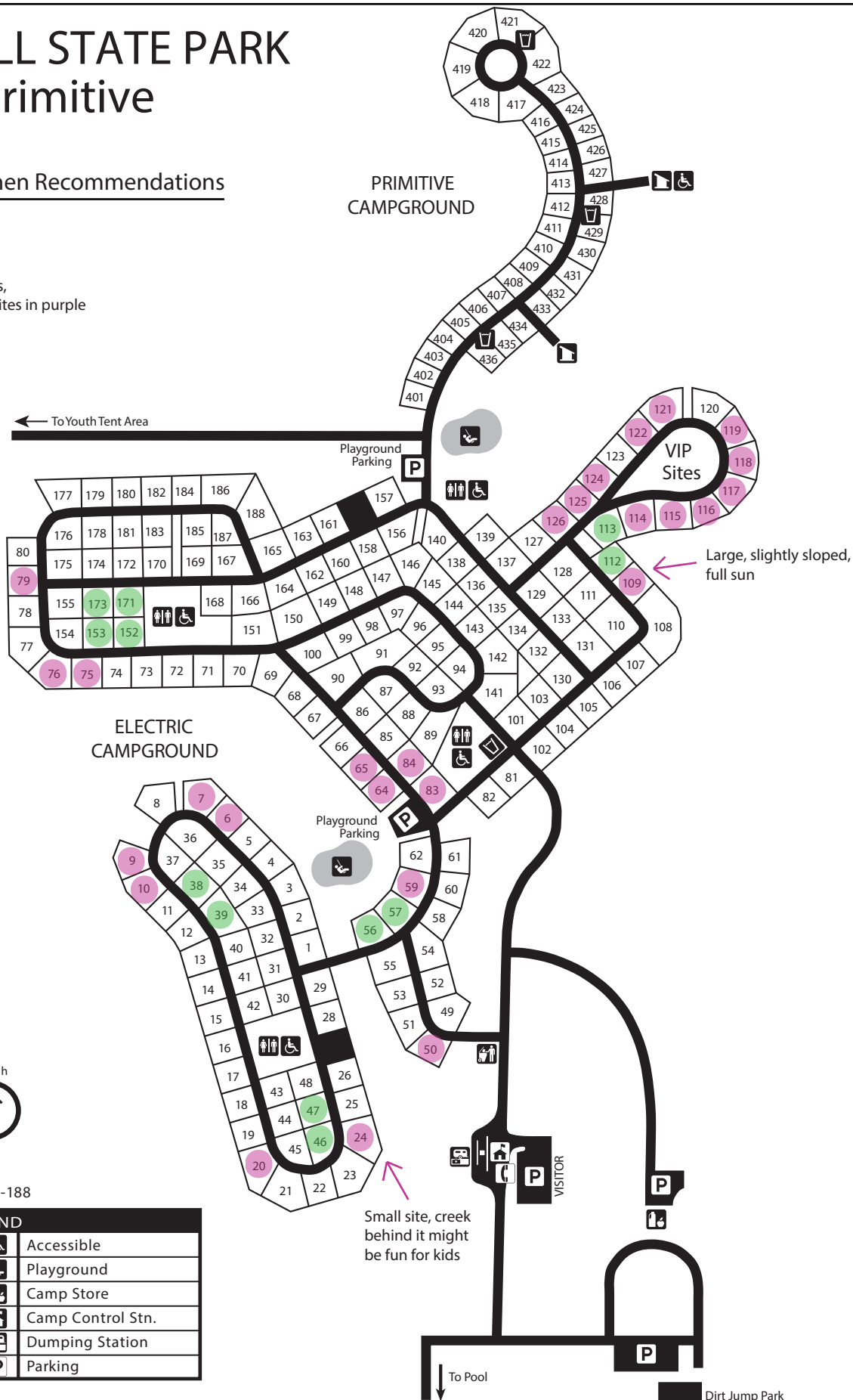

← To Youth Tent Area

Large, slightly sloped, full sun

Small site, creek behind it might be fun for kids

Electric Sites Water Hook-ups: 1-188

| LEGEND | | | |
|--------|-----------------|--|-------------------|
| | Road | | Accessible |
| | Water Hydrant | | Playground |
| | Restroom | | Camp Store |
| | Vault Toilet | | Camp Control Stn. |
| | Dumpster | | Dumping Station |
| | Emergency Phone | | Parking |

NEED ASSISTANCE DURING YOUR STAY?

Please contact the park office, gatehouse or other DNR personnel.
 Park Office: (812) 849-3534
 Dial 911 for all emergencies.

PARK OFFICE HOURS:

Mon.-Fri. 8:30 a.m.-4:00 p.m.
 Weekend & seasonal hours vary.

CHECK IN/OUT TIMES

(by local time)
 Campgrounds Check in/out: 2:00 p.m.
 Sundays and designated holidays check in/out is 5:00 p.m.